

STRUCTURAL BRACKETS RANGE

Extensive structural brackets range specifically designed and fabricated from high grade materials for use in all types of reliable connection methods.

FEATURES AND BENEFITS

SIMPLE: Extensive range to suit most types of common site connections.

FAST: Bolt fix using standard on site tools

DURABLE: 5mm thick HDG galvanised steel. *Excludes SBKFS

SPECIFICATIONS

| | |
|----------------------|--|
| PRODUCT CODE | SBK* |
| STEEL | G300 |
| THICKNESS | 5mm* |
| CORROSION RESISTANCE | Electroplated or Hot Dipped Galvanised |
| FASTENERS REQUIRED | Bolt Fix* |
| HEIGHT | Refer to specific bracket |
| WIDTH | Refer to specific bracket |

* Refer to specific product for code and fixing methods

* SBKFS is only 3mm thick.

At the time of print, this product is NOT subject to any known warnings and bans found in Building Act 2004.



DURABILITY

The following table provides an easy guide when selecting a Pryda product corrosion protection finish that will meet and exceeds NZS 3604:2011 table 4.1.

| ZONE | LOCATION | | ENVIRONMENT | PRODUCT |
|---------------|--|--|-------------|---|
| All Zones | Fully enclosed walls, floors, and roof spaces | | Closed | Pryda Zinc Coated Products Z275 |
| Zones B and C | All subfloor fastenings more than 600mm above the ground | Vented 7000mm ² /m ² or less | Sheltered | Pryda Stainless Steel 304 Products ⁽³⁾ |
| | | Vented MORE than 7000mm ² /m ² | Exposed | Pryda Stainless Steel 304 Products ⁽³⁾ |
| | All subfloor fastenings within 600mm of the ground | Sheltered and Exposed | | Pryda Stainless Steel 304 Products ⁽³⁾ |
| | All other structural fixings | Sheltered | | Pryda Stainless Steel 304 Products ⁽³⁾ |
| | | Exposed | | Pryda Stainless Steel 304 Products ⁽³⁾ |
| Zone D | All structural fixings | Sheltered and Exposed | | Pryda Stainless Steel 304 Products ⁽³⁾ |

Notes:

1. All Pryda galvanised products comply with NZS3604:2011 Table 4.2.
2. Refer to NZS3604:2011 for all environment definitions.
3. Routine inspection and cleaning using soap and fresh warm water is an integral part of the ongoing care and maintenance of stainless steel to preserve its appearance.

STORAGE AND HANDLING

Prior to use, the Pryda products shall be stored in a weatherproof environment and protected from moisture. Care must be taken to avoid any damage to the surface of the product, protective galvanised coating and profile that may impact the performance.

COMPLIES WITH THE FOLLOWING PROVISIONS OF THE NEW ZEALAND BUILDING CODE (NZBC)

Clause B1 STRUCTURE: Performance B1.3.1, B1.3.2 and B1.3.4. Loads arising from self-weight, imposed gravity loads arising from use, earthquake, snow, and wind. (i.e., B1.3.3 (a), (b), (f), (g), and (h)). Only some may apply for a specific use of the component.

Clause B2 DURABILITY: Performance B2.3.1 (a) not less than 50 years and B2.3.2.

Clause F2 HAZARDOUS BUILDING MATERIALS: Performance F2.3.1.

DESIGN CAPACITIES

Pryda SBK structural bracket are supplied as individually described with product dimensions, hole geometry, and fabrication material specifics.

Design capacities can be derived from:

- Engineering first principles by the user/purchaser consulting project Engineer for each component and its intended design.
- The characteristic strength of bolts in timber or steel, using the relevant design code for the intended load directions based on the connection geometry and selected components.

Before use, the end user/purchaser is responsible for checking the suitability and seeking Engineering advice from his/her consulting project structural Engineer for any selected components and deem the components "fit for purpose" for its intended use.

AVAILABLE STRUCTURAL BRACKET RANGE

FLAT STRAPS



SBK 23
SBK 23/S



SBK 25
SBK 25/S

SBK23

| | |
|-----------------------|---------------------|
| STEEL GRADE: | Grade 250 |
| STEEL THICKNESS: | 5mm |
| CORROSION PROTECTION: | HDG to AS/NZS 4680 |
| FASTENER SIZE: | M12 BOLT OR SIMILAR |

SBK23/S

| | |
|-----------------------|---------------------|
| STEEL GRADE: | Stainless Steel 304 |
| STEEL THICKNESS: | 5mm |
| CORROSION PROTECTION: | Stainless Steel |
| FASTENER SIZE: | M12 BOLT OR SIMILAR |

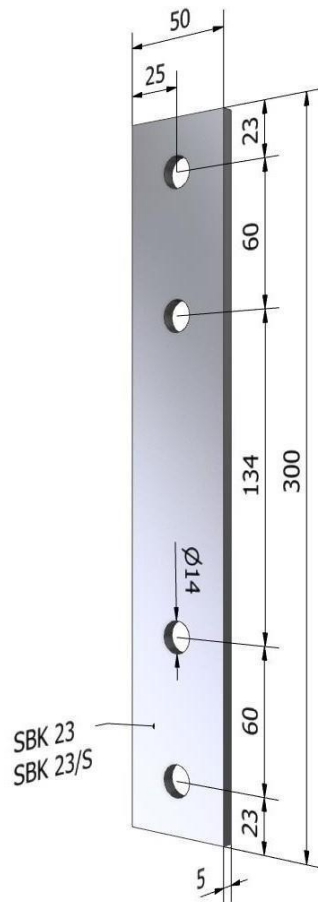

SBK25

| | |
|-----------------------|---------------------|
| STEEL GRADE: | Grade 250 |
| STEEL THICKNESS: | 5mm |
| CORROSION PROTECTION: | HDG to AS/NZS 4680 |
| FASTENER SIZE: | M12 BOLT OR SIMILAR |

SBK25/S

| | |
|-----------------------|---------------------|
| STEEL GRADE: | Stainless Steel 304 |
| STEEL THICKNESS: | 5mm |
| CORROSION PROTECTION: | Stainless Steel |
| FASTENER SIZE: | M12 BOLT OR SIMILAR |

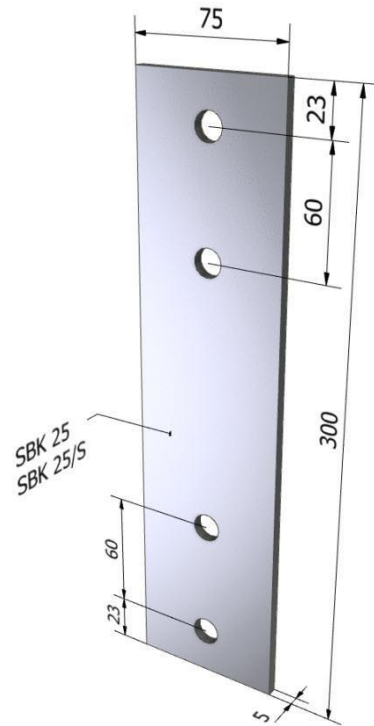

*All dimensions shown are in "mm".

FLAT T-STRAPS



SBK 27

SBK 27/S

SBK27

| | |
|-----------------------|---------------------|
| STEEL GRADE: | Grade 250 |
| STEEL THICKNESS: | 5mm |
| CORROSION PROTECTION: | HDG to AS/NZS 4680 |
| FASTENER SIZE: | M12 BOLT OR SIMILAR |

SBK27/S

| | |
|-----------------------|---------------------|
| STEEL GRADE: | Stainless Steel 304 |
| STEEL THICKNESS: | 5mm |
| CORROSION PROTECTION: | Stainless Steel |
| FASTENER SIZE: | M12 BOLT OR SIMILAR |

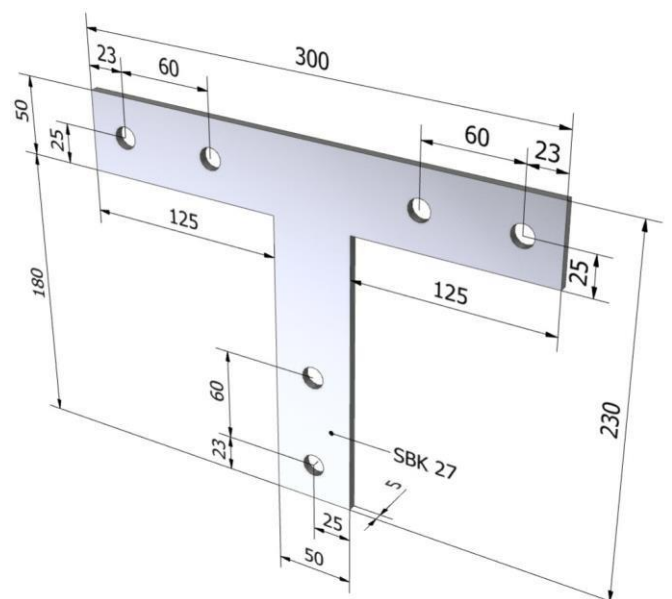

*All dimensions shown are in "mm".

FLAT L-STRAPS



SBK 29
SBK 29/S



SBK 30

SBK29

| | |
|-----------------------|---------------------|
| STEEL GRADE: | Grade 250 |
| STEEL THICKNESS: | 5mm |
| CORROSION PROTECTION: | HDG to AS/NZS 4680 |
| FASTENER SIZE: | M12 BOLT OR SIMILAR |

SBK29/S

| | |
|-----------------------|---------------------|
| STEEL GRADE: | Stainless Steel 304 |
| STEEL THICKNESS: | 5mm |
| CORROSION PROTECTION: | Stainless Steel |
| FASTENER SIZE: | M12 BOLT OR SIMILAR |

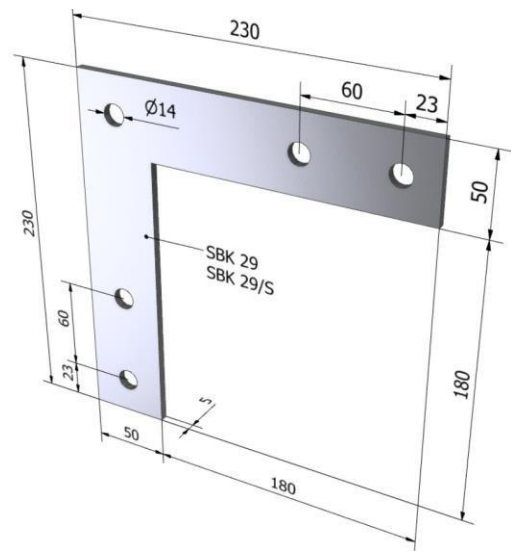

SBK30

| | |
|-----------------------|---------------------|
| STEEL GRADE: | Grade 250 |
| STEEL THICKNESS: | 5mm |
| CORROSION PROTECTION: | HDG to AS/NZS 4680 |
| FASTENER SIZE: | M12 BOLT OR SIMILAR |

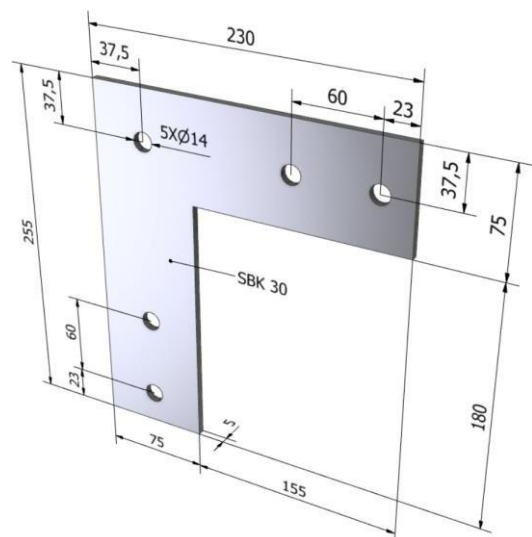

*All dimensions shown are in "mm".

ANGLE BRACKETS



SBK 10A
SBK 10A/S



SBK 14A
SBK 14A/S



SBK 31
SBK 31/S

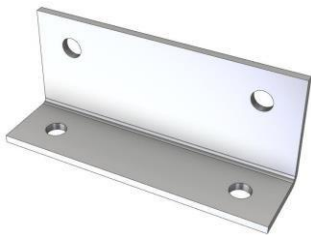

SBK 31A
SBK 31A/S



SBK 33
SBK 33/S



SBK 34



SBK 53
SBK 53/S

SBK10A

| | |
|-----------------------|---------------------|
| STEEL GRADE: | Grade 250 |
| STEEL THICKNESS: | 5mm |
| CORROSION PROTECTION: | HDG to AS/NZS 4680 |
| FASTENER SIZE: | M12 BOLT OR SIMILAR |

SBK10A/S

| | |
|-----------------------|---------------------|
| STEEL GRADE: | Stainless Steel 304 |
| STEEL THICKNESS: | 5mm |
| CORROSION PROTECTION: | Stainless Steel |
| FASTENER SIZE: | M12 BOLT OR SIMILAR |

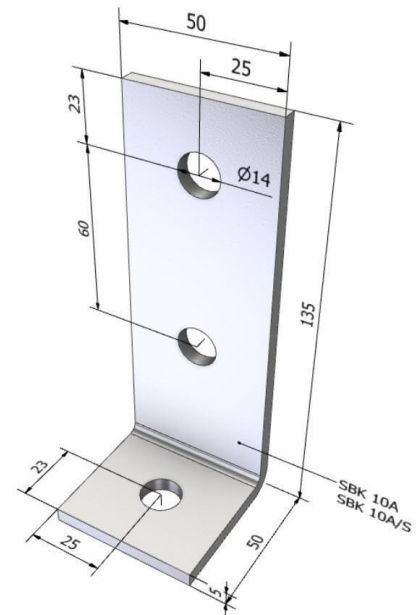

SBK14A

| | |
|-----------------------|---------------------|
| STEEL GRADE: | Grade 250 |
| STEEL THICKNESS: | 5mm |
| CORROSION PROTECTION: | HDG to AS/NZS 4680 |
| FASTENER SIZE: | M12 BOLT OR SIMILAR |

SBK14A/S

| | |
|-----------------------|---------------------|
| STEEL GRADE: | Stainless Steel 304 |
| STEEL THICKNESS: | 5mm |
| CORROSION PROTECTION: | Stainless Steel |
| FASTENER SIZE: | M12 BOLT OR SIMILAR |

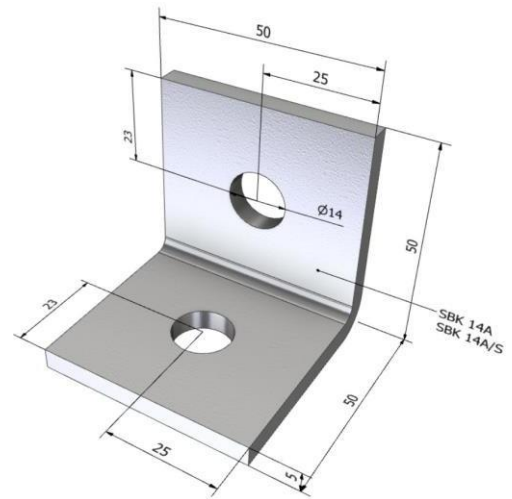

SBK31

| | |
|-----------------------|---------------------|
| STEEL GRADE: | Grade 250 |
| STEEL THICKNESS: | 5mm |
| CORROSION PROTECTION: | HDG to AS/NZS 4680 |
| FASTENER SIZE: | M12 BOLT OR SIMILAR |

SBK31/S

| | |
|-----------------------|---------------------|
| STEEL GRADE: | Stainless Steel 304 |
| STEEL THICKNESS: | 5mm |
| CORROSION PROTECTION: | Stainless Steel |
| FASTENER SIZE: | M12 BOLT OR SIMILAR |

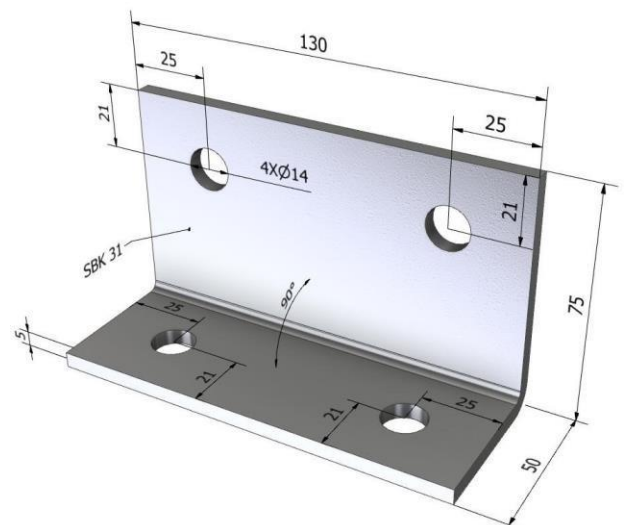

*All dimensions shown are in "mm".

SBK31A

| | |
|-----------------------|---------------------|
| STEEL GRADE: | Grade 250 |
| STEEL THICKNESS: | 5mm |
| CORROSION PROTECTION: | HDG to AS/NZS 4680 |
| FASTENER SIZE: | M12 BOLT OR SIMILAR |

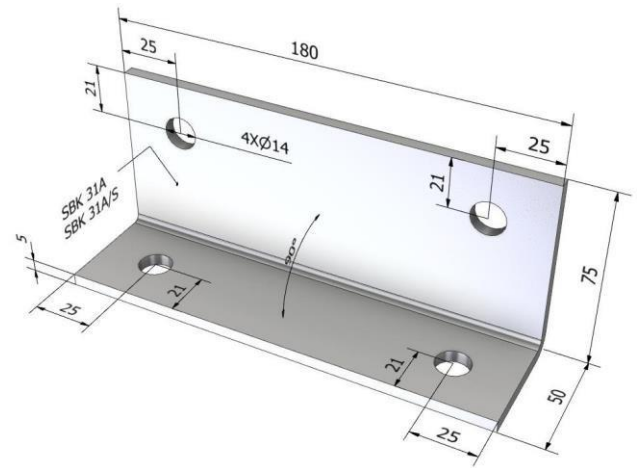

SBK31A/S

| | |
|-----------------------|---------------------|
| STEEL GRADE: | Stainless Steel 304 |
| STEEL THICKNESS: | 5mm |
| CORROSION PROTECTION: | Stainless Steel |
| FASTENER SIZE: | M12 BOLT OR SIMILAR |

SBK33

| | |
|-----------------------|---------------------|
| STEEL GRADE: | Grade 250 |
| STEEL THICKNESS: | 5mm |
| CORROSION PROTECTION: | HDG to AS/NZS 4680 |
| FASTENER SIZE: | M12 BOLT OR SIMILAR |

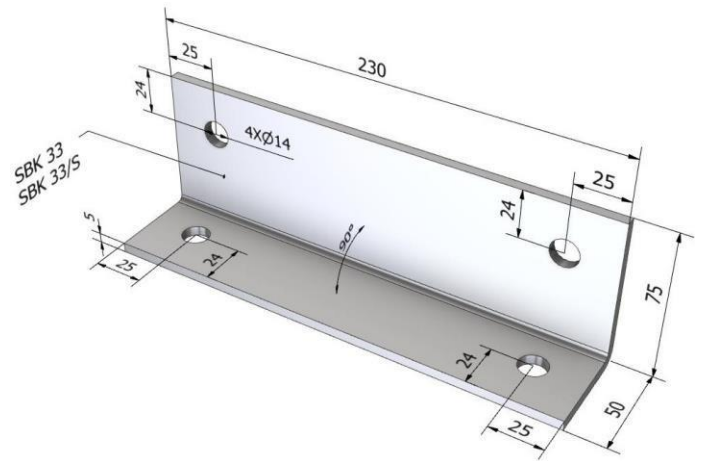

SBK33/S

| | |
|-----------------------|---------------------|
| STEEL GRADE: | Stainless Steel 304 |
| STEEL THICKNESS: | 5mm |
| CORROSION PROTECTION: | Stainless Steel |
| FASTENER SIZE: | M12 BOLT OR SIMILAR |

*All dimensions shown are in "mm".

SBK34

| | |
|-----------------------|---------------------|
| STEEL GRADE: | Grade 250 |
| STEEL THICKNESS: | 5mm |
| CORROSION PROTECTION: | HDG to AS/NZS 4680 |
| FASTENER SIZE: | M12 BOLT OR SIMILAR |

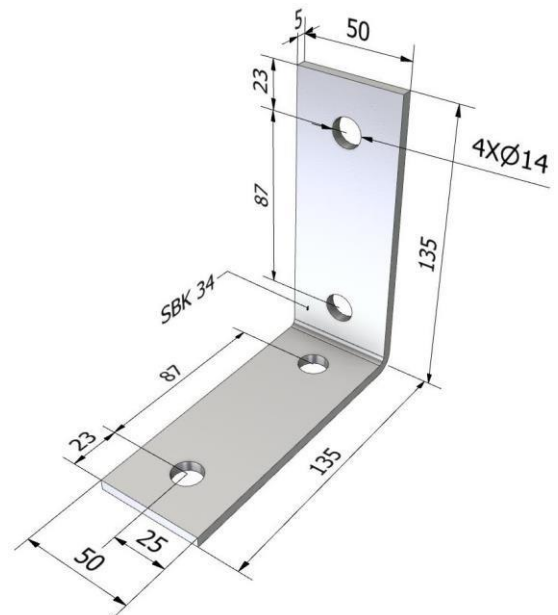

*All dimensions shown are in "mm".

SBK53

| | |
|-----------------------|---------------------|
| STEEL GRADE: | Grade 250 |
| STEEL THICKNESS: | 5mm |
| CORROSION PROTECTION: | HDG to AS/NZS 4680 |
| FASTENER SIZE: | M12 BOLT OR SIMILAR |

SBK53/S

| | |
|-----------------------|---------------------|
| STEEL GRADE: | Stainless Steel 304 |
| STEEL THICKNESS: | 5mm |
| CORROSION PROTECTION: | Stainless Steel |
| FASTENER SIZE: | M12 BOLT OR SIMILAR |

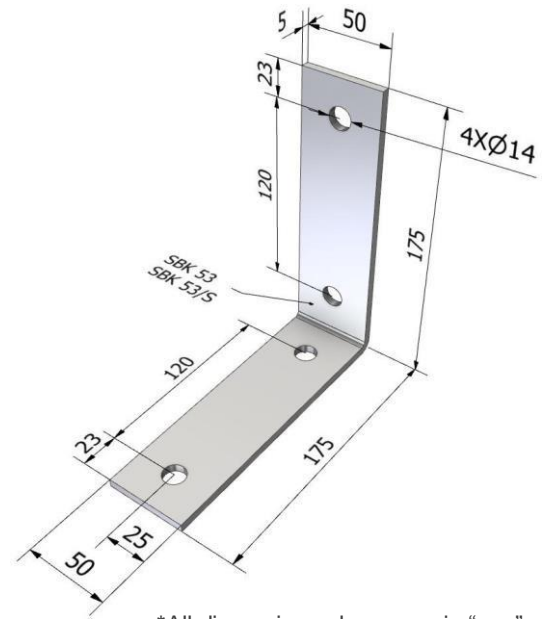

*All dimensions shown are in "mm".

ANGLE BRACKETS WITH GUSSET



SBK 36



SBK 55

SBK36

| | |
|---|--------------------------------------|
| STEEL GRADE: | Grade 250 |
| STEEL THICKNESS: | 5mm |
| CORROSION PROTECTION: | HDG to AS/NZS 4680 |
| WELD TO UNDERSIDE OF EACH BEARING PLATE | 5mm CFW SP Category to AS/NZS 1554.1 |
| FASTENER SIZE: | M12 BOLT OR SIMILAR |

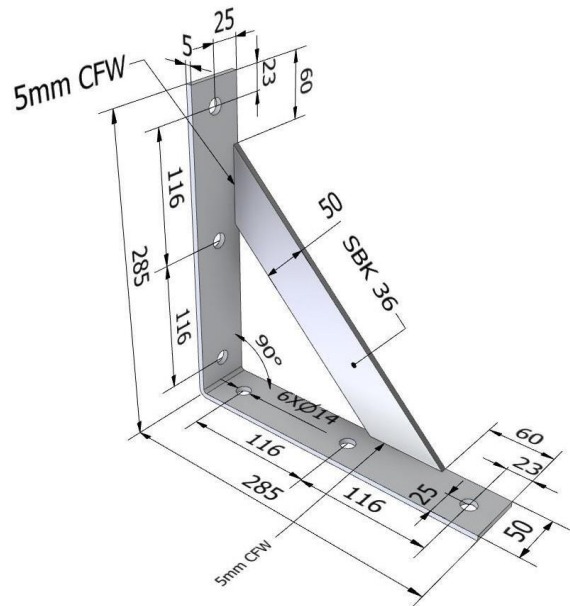

SBK55

| | |
|-----------------------|---------------------|
| STEEL GRADE: | Grade 250 |
| STEEL THICKNESS: | 5mm |
| CORROSION PROTECTION: | HDG to AS/NZS 4680 |
| FASTENER SIZE: | M12 BOLT OR SIMILAR |

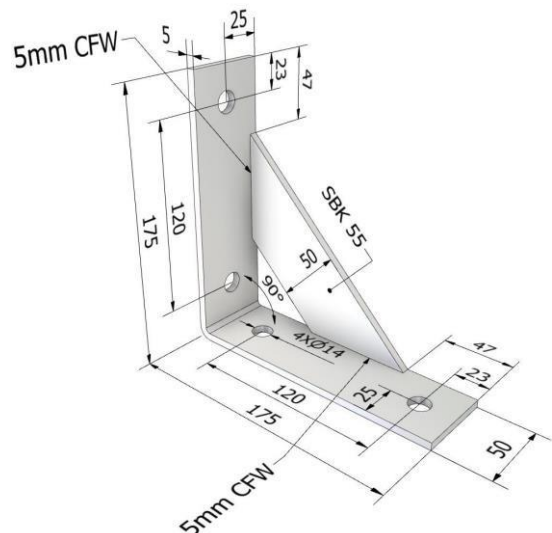

BEAM SUPPORTS



SBK 38



SBK 38A

SBK38

| | |
|---|--------------------------------------|
| STEEL GRADE: | Grade 250 |
| STEEL THICKNESS: | 5mm |
| CORROSION PROTECTION: | HDG to AS/NZS 4680 |
| WELD TO UNDERSIDE OF EACH BEARING PLATE | 5mm CFW SP Category to AS/NZS 1554.1 |
| FASTENER SIZE: | M12 BOLT OR SIMILAR |

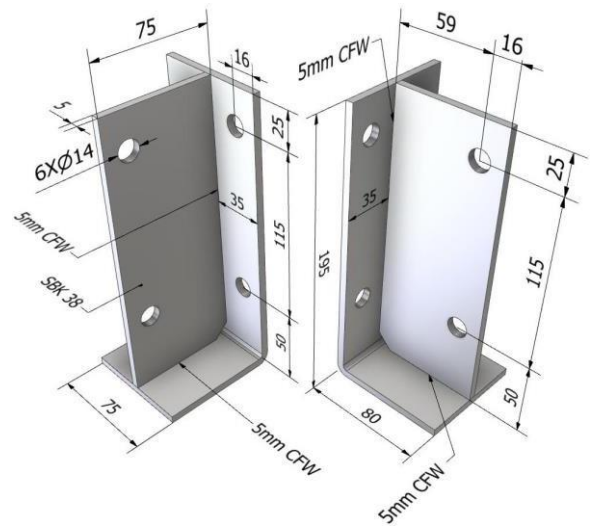

SBK38A/S

| | |
|-----------------------|---------------------|
| STEEL GRADE: | Stainless Steel 304 |
| STEEL THICKNESS: | 5mm |
| CORROSION PROTECTION: | Stainless Steel |
| FASTENER SIZE: | M12 BOLT OR SIMILAR |

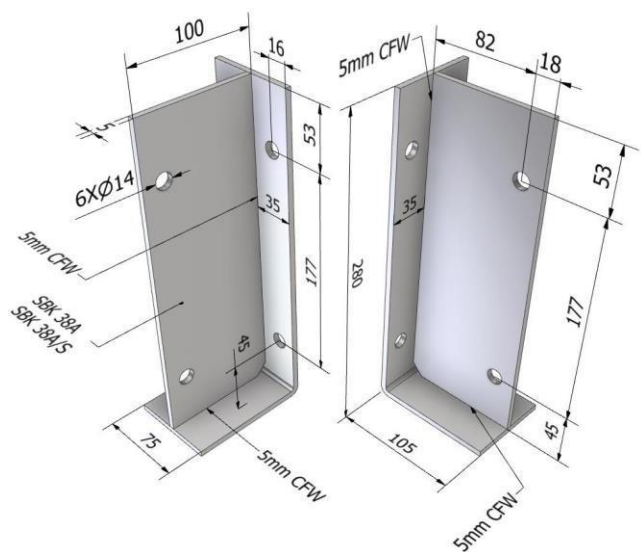

*All dimensions shown are in "mm".

POLE BRACE BRACKET

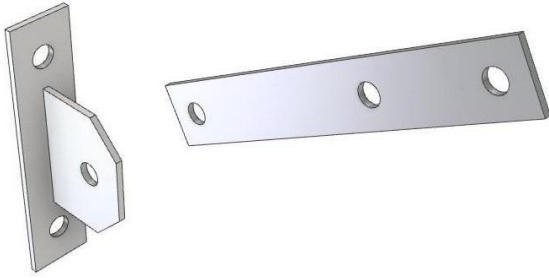

SBK 57/S

SBK57/S

| | |
|-----------------------|---------------------|
| STEEL GRADE: | Stainless Steel 304 |
| STEEL THICKNESS: | 5mm |
| CORROSION PROTECTION: | Stainless Steel |
| FASTENER SIZE: | M16 BOLT OR SIMILAR |

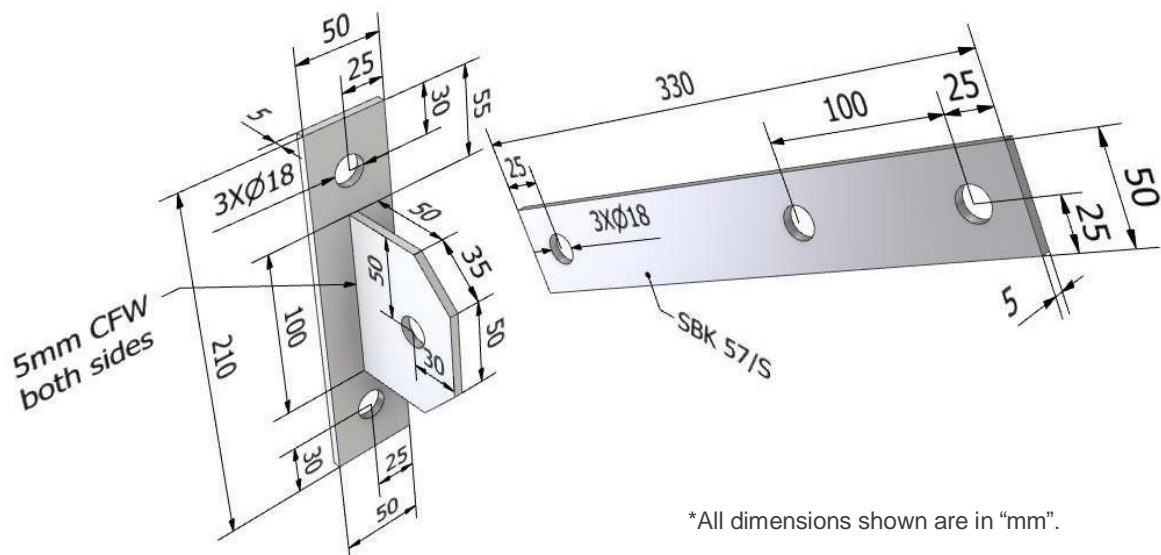

*All dimensions shown are in “mm”.

POST AND BEARER SUPPORTS



SBK 4
SBK 4/S



SBK 6
SBK 6/S



SBK 8
SBK 8/S



SBK 9



SBK 18

SBK4

| | |
|-----------------------|---------------------|
| STEEL GRADE: | Grade 250 |
| STEEL THICKNESS: | 5mm |
| CORROSION PROTECTION: | HDG to AS/NZS 4680 |
| FASTENER SIZE: | M12 BOLT OR SIMILAR |

SBK4/S

| | |
|-----------------------|---------------------|
| STEEL GRADE: | Stainless Steel 304 |
| STEEL THICKNESS: | 5mm |
| CORROSION PROTECTION: | Stainless Steel |
| FASTENER SIZE: | M12 BOLT OR SIMILAR |

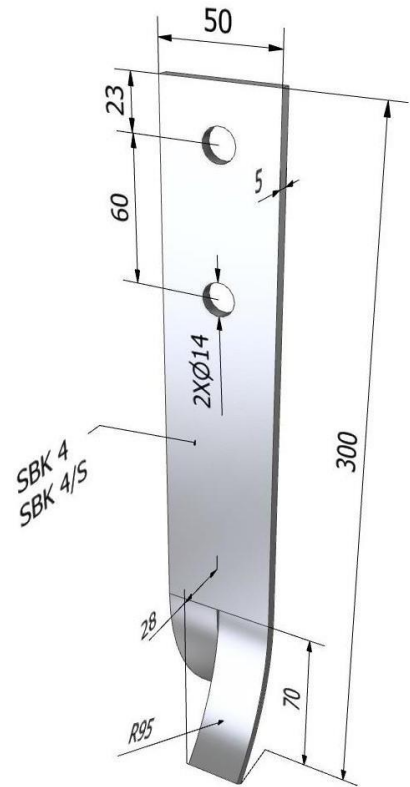

SBK6

| | |
|---|--------------------------------------|
| STEEL GRADE: | Grade 250 |
| STEEL THICKNESS: | 5mm |
| CORROSION PROTECTION: | HDG to AS/NZS 4680 |
| WELD TO UNDERSIDE OF EACH BEARING PLATE | 5mm CFW SP Category to AS/NZS 1554.1 |
| FASTENER SIZE: | M12 BOLT OR SIMILAR |

SBK6/S

| | |
|-----------------------|---------------------|
| STEEL GRADE: | Stainless Steel 304 |
| STEEL THICKNESS: | 5mm |
| CORROSION PROTECTION: | Stainless Steel |
| FASTENER SIZE: | M12 BOLT OR SIMILAR |

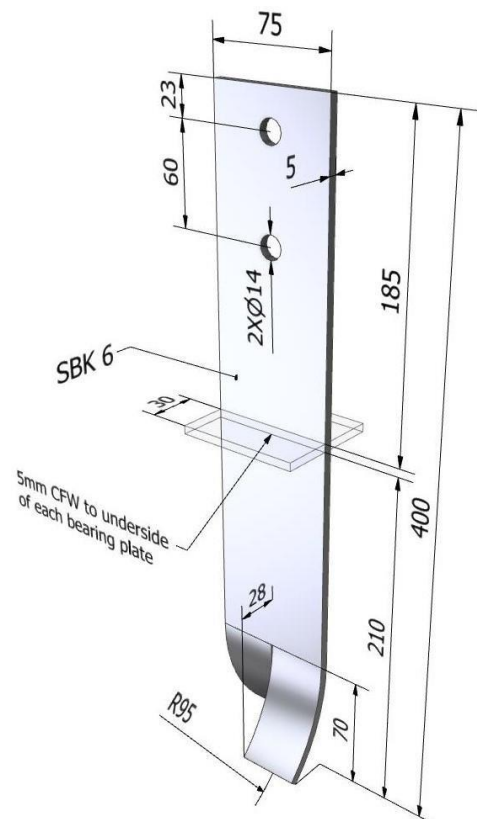

*All dimensions shown are in "mm".

SBK8

| | |
|-----------------------|---------------------|
| STEEL GRADE: | Grade 250 |
| STEEL THICKNESS: | 5mm |
| CORROSION PROTECTION: | HDG to AS/NZS 4680 |
| FASTENER SIZE: | M12 BOLT OR SIMILAR |

SBK8/S

| | |
|-----------------------|---------------------|
| STEEL GRADE: | Stainless Steel 304 |
| STEEL THICKNESS: | 5mm |
| CORROSION PROTECTION: | Stainless Steel |
| FASTENER SIZE: | M12 BOLT OR SIMILAR |

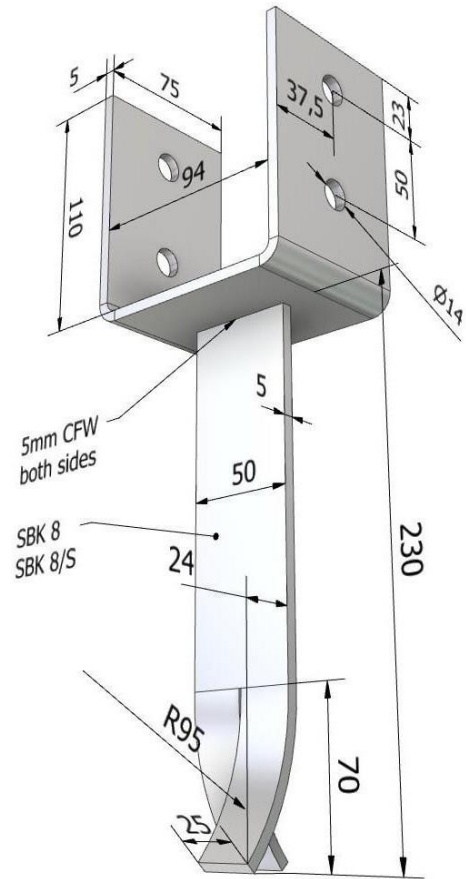

SBK9

| | |
|-----------------------|---------------------|
| STEEL GRADE: | Grade 250 |
| STEEL THICKNESS: | 5mm |
| CORROSION PROTECTION: | HDG to AS/NZS 4680 |
| FASTENER SIZE: | M12 BOLT OR SIMILAR |

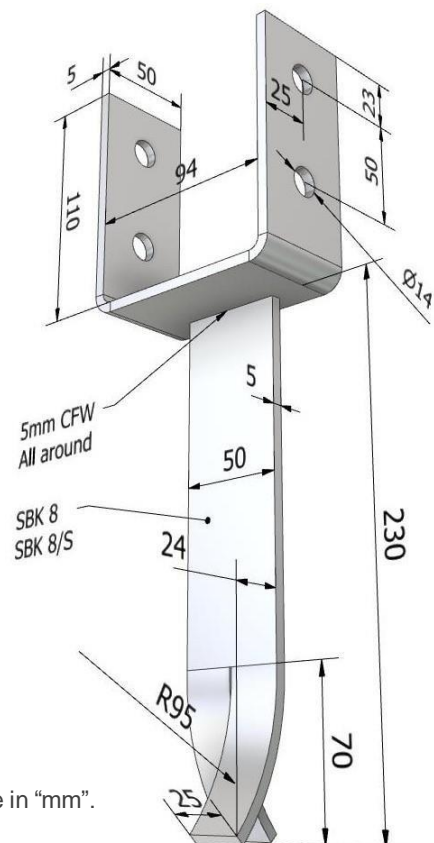

*All dimensions shown are in "mm".

SBK18

| | |
|-----------------------|---------------------|
| STEEL GRADE: | Grade 250 |
| STEEL THICKNESS: | 5mm |
| CORROSION PROTECTION: | HDG to AS/NZS 4680 |
| FASTENER SIZE: | M12 BOLT OR SIMILAR |

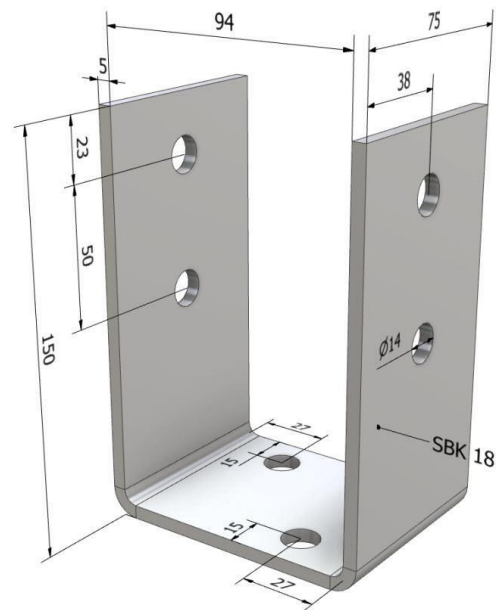

*All dimensions shown are in "mm".

FENCE STAY BRACKET



SBKFS

SBKFS

| | |
|-----------------------|------------------------------|
| STEEL GRADE: | Grade 250 |
| STEEL THICKNESS: | 3mm |
| CORROSION PROTECTION: | HDG to AS/NZS 4680 |
| FASTENER SIZE: | NO.12 GAUGE SCREW OR SIMILAR |

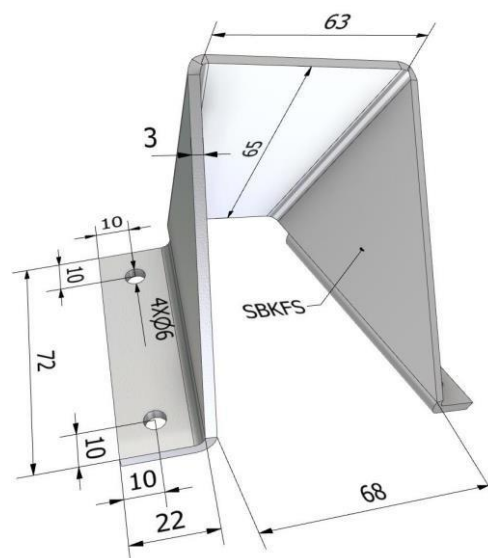

*All dimensions shown are in "mm".

| Contact details | | Contact details | |
|--|--|--|--|
| Manufacture location | Overseas | Manufacture location | New Zealand |
| Legal and trading name of manufacturer | Wigley Engineering PTY LTD | Legal and trading name of manufacturer | Kimberly Tool & Design (NZ) Limited |
| Legal and trading name of supplier | Pryda New Zealand -a Division of ITW New Zealand | Legal and trading name of supplier | Pryda New Zealand -a Division of ITW New Zealand |
| Supplier address for service | 23-29 Poland Road, Wairau Valley, Auckland, 0627, New Zealand | Supplier address for service | 23-29 Poland Road, Wairau Valley, Auckland, 0627, New Zealand |
| Supplier website | Pryda.co.nz | Supplier website | Pryda.co.nz |
| Supplier email | info@prydaanz.com | Supplier email | info@prydaanz.com |
| Supplier phone number | 0800 88 22 44 | Supplier phone number | 0800 88 22 44 |
| Supplier NZBN | 9429039833129 | Supplier NZBN | 9429039833129 |
| Product skus | SBK27, SK27/S, SBK29, SBK29/S, SBK30, SBK23, SBK23/S, SBK25, SBK25/S | Product skus | SBK10A, SBK10A/S, SBK14, SBK14A/S, SBK31, SBK31/S, SBK31A, SBK31A/S, SBK33, SBK33/S, SBK34, SBK53, SBK53/S, SBK36, SBK55, SBK38, SBK38A/S, SBK57/S, SBK4, SBK4/S, SBK6, SBK6/S, SBK8, SBK8/S, SBK9, SBK18, SBKFS |